

## DAISY CRESENT PRISMATIC

Direct | Surface

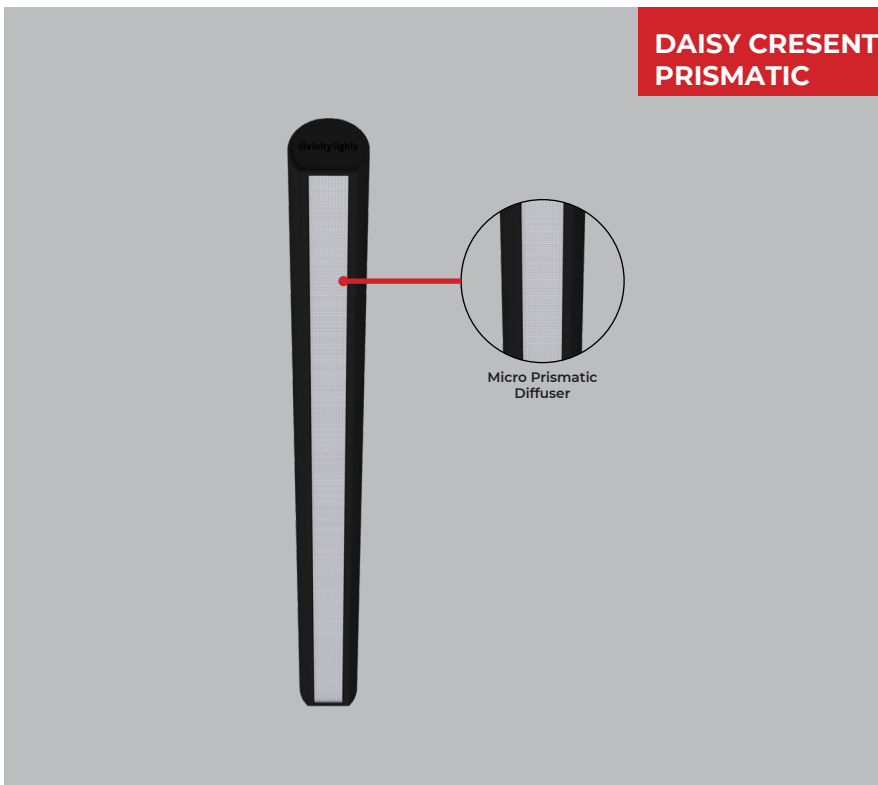

**DAISY CRESENT PRISMATIC** Linear Luminaire in a sleek design with Extruded aluminium housing and with premium powder coating finish.

Powered by high-quality LED's with a binning tolerance of  $\leq 3$  SDCM and  $\text{CRI} \geq 90$ . The luminaire maintains atleast 70% of its luminous flux after 50,000 operating hours, guaranteeing long-term reliability. High efficiency Micro Prismatic double diffuser provides uniform illumination and reduces glare.

With a standard size of 1200 mm length, 66 mm height and 80 mm diameter, this fixture is crafted for direct light distribution making it ideal for professional applications.

Customisations in RAL finish, Wattages and Length available as per request to enhance installation and functionality.

### Single Line Diagram

Surface

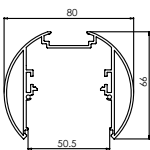

## DAISY CRESENT PRISMATIC



### Quick Info

#### Mounting Type

Surface

#### Material Colour

Customize RAL available

#### Protection mode

IP40

#### Driver Details

ON/OFF/, DALI-2 DT6 / DALI-2 DT8/ DALI +

Power Factor (PF) -0.95

THD- <10%

UGR - <19

#### LED

CCT- 3000K/ 4000K/ 5700K/ TUNABLE WHITE 2700K-6500K

CRI-  $\geq 90$

Life Span - L70@50000h

MacAdam -  $\leq 3$  SDCM

#### Beam Angle

110°

#### Optics

Opal Diffuser

Micro Prismatic Diffuser

#### Efficacy

3000K- 105.6

4000K- 120.7

5700K- 130.0

Tunable White 2700K-6500K- 120.7

#### Electrical

Wattage - 28W/4ft

Opt Wattages Available - 15W/4ft, 20W/4ft, 25W/4ft

Input Voltage- 220-240 VAC

#### Physical

Length- 1200mm

Height- 66 mm

Diameter- 80 mm